

PROPORTIONAL

Proportional soft rejection / stable pneumatic divider.

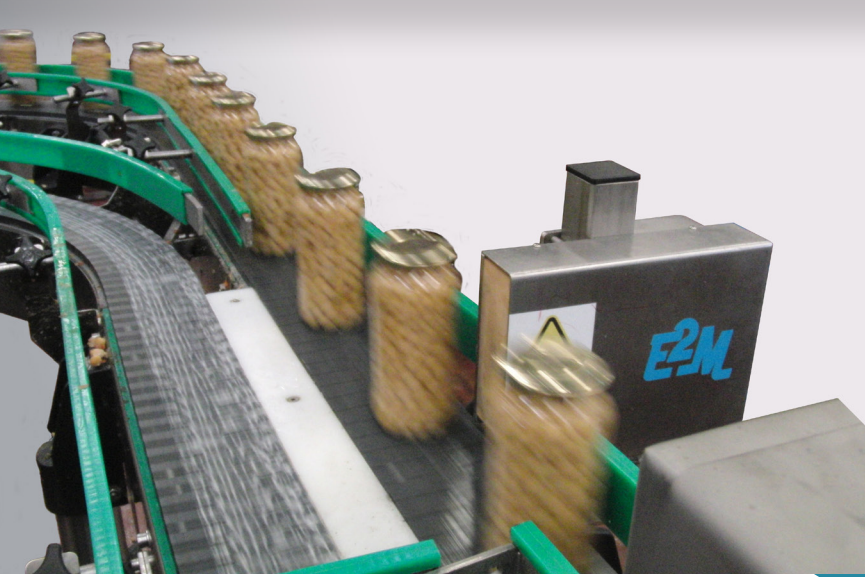

- ✓ Silent system.
- ✓ Easy installation on existing conveyor.
- ✓ Compact and robust design.
- ✓ Minimum preventive maintenance.
- ✓ Water jet cleaning for dripping lines of dairy or sticky content.
- ✓ Long life system and fast amortization.
- ✓ High accuracy.

DESCRIPTION

It moves the containers that circulate on a conveyor, smoothly and without losing their stability, by means of a mechanism composed of a cylinder, a proportional solenoid valve and a shovel.

The rejection / diversion element is the shovel, which is always prepared to push the container that passes by, while waiting for the following rejection order. After receiving the order, the system pushes and guides the container to another lane. Speed and acceleration profile are established according to the characteristics of the container. The parameters of each format are programmed by the user and stored in the memory with a number for each container in production.

FEATURES

- Sizes: 200x300x700mm on the conveyor, including the control unit.
- Production capacity: up to 70,000 containers / hour.
- Maximum weight of the containers: 8Kg.
- Handled by a microprocessor to control all parameters.
- 2 ramps for acceleration, deceleration, approach speed, maximum speed, etc.
- Everything is programmable and memorizable for each container in production.

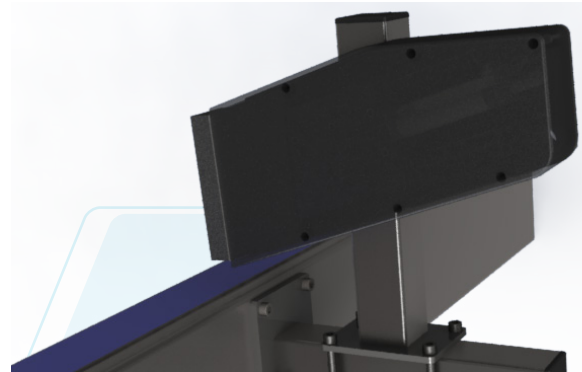

ORIENTING | INSPECTING | REJECTING

ANY KIND OF EMPTY OR FULL BOTTLES AND CONTAINERS

PROPORTIONAL

Proportional soft rejection / stable pneumatic divider.



VELOCITY

70.000 BOTTLES/HOUR



GAP

$< \frac{1}{2} \cdot \emptyset$

SCOPE

Rejection system for any type of full or empty and stable container. No need for separation between containers. For high-speed production lines to carry out the following functions:

REJECTION

When the automatic inspection system detects any defect in the container, the rejection system diverts it to an adjacent lane / rejection table. It is also used in manual random inspection.

CLASSIFICATION

By means of an electronic inspection the different types of containers are detected. The rejection system distributes them in different lanes according to shape, height, color, etc.

DIVIDER

By means of a sequential control the containers on the conveyor are distributed in several lanes. It is a typical application to prepare the containers for packing. Easily programmable by the user. Adjustment of the diverting sequence and the number of consecutive packages.

Both in the classification and in the division, with a single electronic diverter, 3 lanes can be obtained thanks to a high precision technique:

- 1st: containers pass by – no diversion.
- 2nd: containers are slightly deviated.
- 3rd: containers are deviated at a larger distance.

COMPONENTS

The components have been carefully selected to meet the requirements of high speed and minimum maintenance. The rejection system's elements (solenoid valve, cylinder, pressure switch and rejection shovel) are placed inside a stainless steel enclosure that is fixed on the conveyor. Outside the enclosure there is a filter for air pressure regulation.



Estudis Electro-Mecànics, S.L.

Pau Vila i Dinarés, 4-10

08192 Sant Quirze del Vallès, Barcelona, Spain

T. +34 93 720 85 40 F. +34 93 720 85 25

www.e2m.es

SECURITY

- It meets and exceeds all safety standards required in the industry.
- The electronic equipment complies with the low voltage regulations and has passed the electromagnetic compatibility tests and the quality and lifespan tests in harsh environments.
- All elements have minimum IP65 protection degree.

PROPERTIES

- It is installed on the conveyor and does not require any mechanical modifications.
- It occupies little space: reading head of 5 cm.
- It can be adjusted to different shapes and heights of container.
- Possibility of connection via serial port to: computer, distributed control network, remote diagnosis, etc.

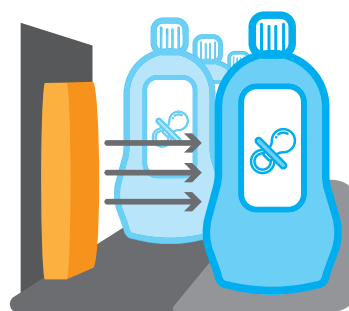

OUR NETWORKS



GET UPDATE!

E2m offers customized solutions to meet specific requirements of each customer.
Technical specifications updated on the website.